

Orona 3G

X-28

Machine-room above electrical gearless solutions

With the latest direct drive technology in public buildings. Less noise and more accessible maintenance. The large-scale customised solution with a machine room, with maximum performance and maintenance efficiency.

General specifications

Load	1,650 to 2,500 kg
Capacity	22 to 33 persons
Speed	0.6 - 1 - 1.6 m/s
Maximum travel	50 - 50 - 75 m
Maximum floors served	32 floors
Entrances	1 front / 2 open through
Drive system	Direct gearless
Controller	ARCA II controller, low energy consumption multiprocessor
Door types	Automatic side-opening / Automatic central-opening
Clear door opening	From 900 to 2,500 mm (in increments of 100 mm)
Door height	2,000 / 2,100 / 2,200 / 2,300 mm
Car dimensions	Parametric car dimensions
Internal car height	2,100 / 2,200 / 2,300 / 2,400 mm
Aesthetic solutions	Orona 3G Plus

Standard Optional



1 DRIVE

Compact, quiet, gearless, energy efficient, speed regulated (VVVF) permanent magnet electric motor.



2 AUTOMATIC RESCUE SYSTEM

With floor level indication to ensure fast, efficient and safe evacuation of passengers in the event of an emergency. As an option, the system can incorporate a fully-automatic rescue device to evacuate passengers in the event of a power failure.



3 SOLID DOORS

Extra robust doors with reduced sound levels inside and outside the lift and which are specially constructed for high volume passenger traffic.



4 MACHINE-ROOM

A traditional solution simplifying lift maintenance.



5 PARAMETRIC/FLEXIBLE

Flexible car and door configurations ensure available shaft dimensions can be optimised (optional).



6 ROBUST LIFT CAR

Provides greater comfort during lift travel, with reduced vibration and noise.



7 CARS

Reinforced wall panels and flooring provides durability for heavy duty usage. Flexible configurations offering optimum car and door dimensions.



8 ACCESSIBLE SPACE BELOW THE PIT

Adapts the lift to suit buildings which have an accessible space below the pit (optional).



Standard dimensions

Load / capacity				Car				Lift shaft *					
Speed			Q Load	AC Width	FC Depth	PL Clear opening	Type	No. of entrances	AH ¹ Width	FH Depth	HF ² Pit	HUP ³ Headroom	
0.6 m/s		24	1,800 kg	2,350	1,600	1,200	CC	1 2 x 180 ⁰	3,150	1,950 2,160	1,450	3,400	
				2,350	1,700	1,200	CC	1 2 x 180 ⁰		2,050 2,260			
		1,500	2,700	1,300	TT	1 2 x 180 ⁰	2,300 3,050 3,260						
	26	2,000 kg	1,800	2,700	1,300	TT	1 2 x 180 ⁰	2,600	3,050 3,260				
			24	1,800 kg	2,350	1,600	1,200	CC	1 2 x 180 ⁰	1,950 2,160			
					2,350	1,700	1,200	CC	1 2 x 180 ⁰	2,050 2,260			
1 m/s		26	2,000 kg	1,500	2,700	1,300	TT	1 2 x 180 ⁰	2,300	3,050 3,260			
				1,800	2,700	1,300	TT	1 2 x 180 ⁰	2,600	3,050 3,260			
		24	1,800 kg	2,350	1,600	1,200	CC	1 2 x 180 ⁰	3,150	2,050 2,260			
	2,350			1,700	1,200	CC	1 2 x 180 ⁰	3,150	2,050 2,260				
	1.6 m/s		26	2,000 kg	1,500	2,700	1,300	TT	1 2 x 180 ⁰	2,300	3,050 3,260	1,600	3,565
					1,800	2,700	1,300	TT	1 2 x 180 ⁰	2,600	3,050 3,260		
24			1,800 kg	2,350	1,600	1,200	CC	1 2 x 180 ⁰	3,150	2,050 2,260			
		2,350		1,700	1,200	CC	1 2 x 180 ⁰	3,150	2,050 2,260				

1 With TT doors

2 With PVC flooring. Marble floor option + 20 mm

3 HUP minimum for internal car height (HC) 2,100 mm.

* Minimum plumb measurements

CC - Two panel central door

TT - Two panel telescopic door

Layout

1 ENTRANCE

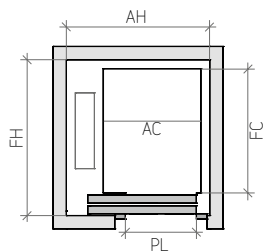

2 ENTRANCES (OPEN THROUGH)

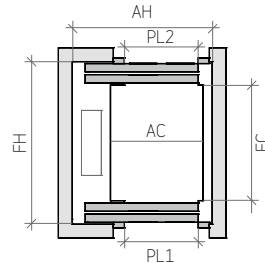

VERTICAL SECTION

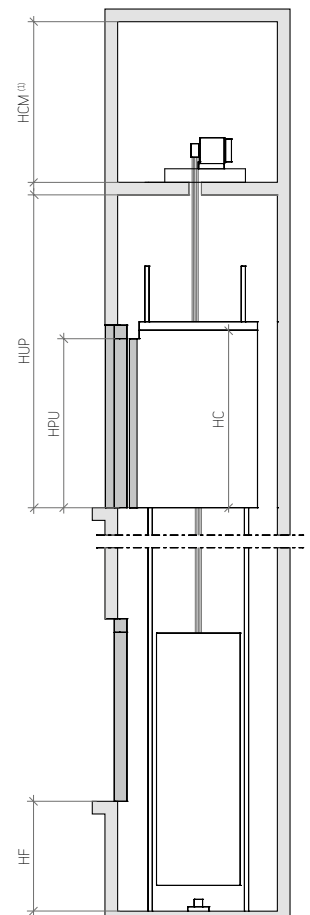

Customised car dimensions

		Car width															
		33	31	30	29	27	25	24	23	22	1900	1800	1700	1600	1500	1400	
Car depth	3,000																
	2,900																
	2,800																
	2,700																
	2,600																
	2,500																
	2,400																
	2,300																
	2,200																
	2,100																
	2,000																
	1,900																
	1,800																
	1,700																
	1,600																
	1,500																
1,400																	
	3,000	2,900	2,800	2,700	2,600	2,500	2,400	2,300	2,200	2,100	2,000	1,900	1,800	1,700	1,600	1,500	1,400

Clear door opening

Note: Car width and depth variable in increments of 5 mm.

For simplification, table samples show increments of 100 mm.

(1) HCM - minimum 2000 mm